

HARDISHINGLE™ INSTALLATION INSTRUCTIONS FOR INDIVIDUAL SHINGLES



James Hardie®

AUGUST 2002

IMPORTANT: FAILURE TO INSTALL AND FINISH HARDISHINGLE™ STRAIGHT EDGE PANELS FOR SIDEWALL APPLICATIONS IN ACCORDANCE APPLICABLE BUILDING CODE COMPLIANCE REPORTS AND JAMES HARDIE'S WRITTEN APPLICATION INSTRUCTIONS, MAY AFFECT SYSTEM PERFORMANCE, VIOLATE LOCAL BUILDING CODES REQUIREMENTS, AND VOID THE PRODUCT ONLY WARRANTY.

HANDLING & STORAGE:

Store panels flat on a smooth level surface, under cover. If panels become saturated, allow to dry prior to installation. Protect edges and corners from breakage.

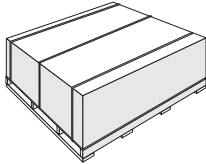

CUTTING OPTIONS:

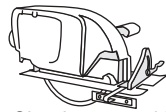

Circular saw with dust collector



Circular saw blade with carbide-tipped teeth

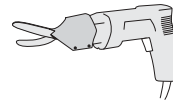

Electric or pneumatic hand shear

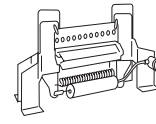

Pneumatic shear



Carbide score and snap knife



▲ JH recognizes Makita® #5044KB 4" or #5057KB 7-1/4" saw with dust collection. Call 800-4MAKITA.
▲ Hitachi® HARDIBLADE® w/4 PCD Diamond Teeth. Call Hitachi® at 800-546-1666 for nearest dealer.
▲ SNAPPER SHEAR™ electric, pneumatic, or hand shear. Call 800-297-7487 for tool information.

Always wear safety glasses and dust protection when operating power tools. For more information on avoiding inhalation refer to the MATERIAL SAFETY DATA SHEET available wherever James Hardie fiber-cement products are sold.

FRAMING REQUIREMENTS

Install Hardishingle Individual Shingles on exterior walls braced in accordance with: The BOCA National Building Code/1999, Section 2305.7; 1997 Standard Building Code, Section 2308.2; 1997 Uniform Building Code, Sections 2320.11.3 and 2320.11.4; 2000 International Building Code, Section 2308.9.3; and 2000 International Residential Code for One- and Two-Family Dwellings, Section R602.10.

Use a weather-resistive barrier in accordance with: The BOCA National Building Code/1999, Section 1403.3; SBCCI 1997 Standard Building Code, Section 2303.3; ICBO 1997 Uniform Building Code, Section 1402.1; ICC 2000 International Building Code, Section 1403.2; and ICC 2000 International Residential Code for One- and Two-Family dwellings, Section R703.2.

GRADE CLEARANCE

Install Hardishingle cladding in compliance with local Building Code requirements for clearance between the bottom edge of panel/framing and the adjacent finished grade.

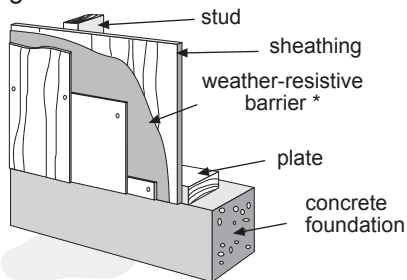
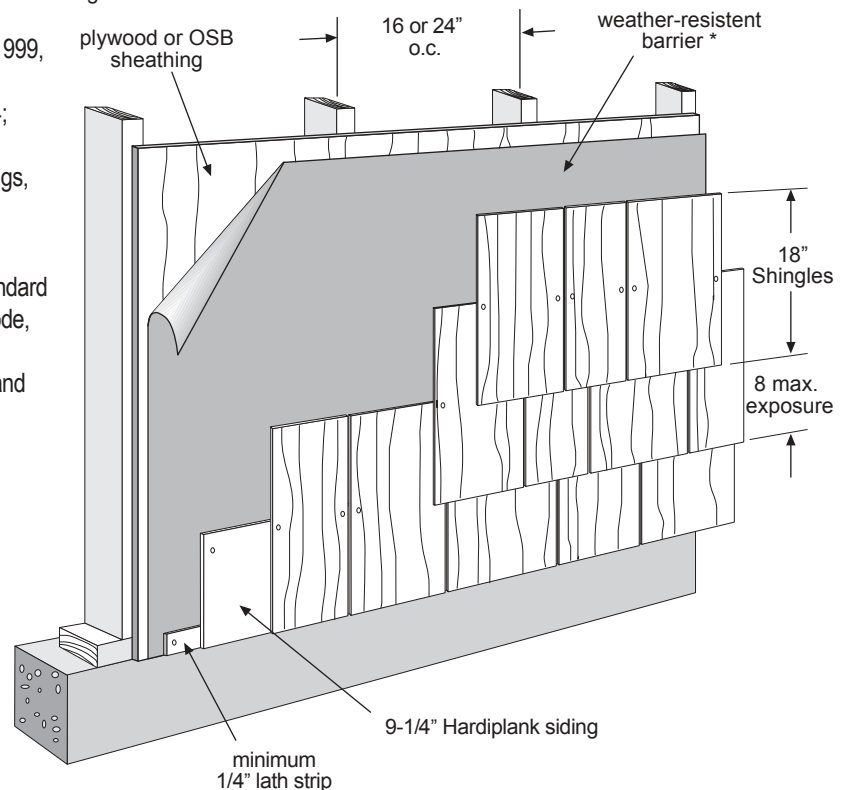

Figure 1 - Double Wall Construction



James Hardie's seal indicates products recognized for use by James Hardie Building Products

APPROVALS: HARDISHINGLE™ individual shingles are recognized as an exterior wall cladding in National Evaluation Report No. NER-405 (BOCA, ICBO, ICC, SBCCI); City of Los Angeles, Research Report No. 24862; US Dept. of HUD Materials Release 1263b; California DSA PA-019; Texas Department of Insurance Evaluation Report EC-23; and City of New York MEA 223-93M. These documents should also be consulted for additional information concerning the suitability of this product for specific applications.

WARNING: AVOID BREATHING SILICA DUST

Product contains Silica. Inhalation of respirable silica dust can cause silicosis a potentially disabling lung disease, and is known to the State of California to cause lung cancer. When drilling, cutting, or abrading product during installation or handling, (1) Work outdoors where feasible, otherwise use mechanical ventilation, (2) Wear a dust mask or, if dust may exceed PEL, use NIOSH/MSHA approved respirator, (3) Warn others in area. For further information, refer to material safety data sheet or consult employer.

FAILURE TO ADHERE TO WARNINGS, MSDS, AND INSTALLATION INSTRUCTIONS MAY LEAD TO SERIOUS PERSONAL INJURY.

